



**KILAT**

14027

**KEDUTAAN BESAR REPUBLIK INDONESIA  
SEOUL**

380, Yoidaebang-ro, Youngdeungpo-gu, Seoul 150-895, Republik Korea  
Tel. (82-2)783-5675/7, 783-5371/2 Fax. (82-2)780-4280 E-mail seoul.kbri@kemlu.go.id

**Kepala Perwakilan RI**

**GANDI SULISTIYANTO**  
**DUTA BESAR LBBP**

**BERITA BIASA**

Nomor : B-00094/Seoul/230329  
Kepada Yth : 1. Menteri Luar Negeri u.p. Sekretaris Jenderal  
2. Menteri Pendidikan, Kebudayaan, Riset, dan Teknologi u.p. Sekretaris Jenderal  
3. Kepala Badan Riset dan Inovasi Nasional (BRIN) u.p. Sestama  
Info Yth : Direktur Asia Timur, Kapusdiklat – Kemlu; Plt. Dirjen Diktiristek, Plt. Biro SDM-Kemdikbudristek  
Dari : Kepala Perwakilan RI  
Jumlah : 29 Halaman  
Perihal : **Penyampaian Tawaran Beasiswa Program KOICA-Seoul National University Master's Degree Program bidang Energy Policy, Fall Semester Tahun 2023**

**RINGKASAN BERITA**

KBRI Seoul telah menerima tawaran program KOICA-SNU *Master's Degree Program in Energy Policy*, Fall Semester Tahun 2023. Bagi mahasiswa yang diterima di Program ini, biaya yang akan ditanggung dalam beasiswa mulai 15 Agustus 2023 hingga 31 Desember 2024 antara lain tuition fee, tiket pesawat pp, tunjangan bulanan, akomodasi, asuransi, biaya kegiatan konferensi, dan beberapa kegiatan lainnya.

KBRI Seoul memandang kesempatan menempuh program beasiswa KOICA-SNU Master's Degree Program dalam bidang Energy Policy ini sangat bagus dalam upaya mendukung sumber daya manusia Indonesia di bidang Energi. Bidang energi telah menjadi program prioritas pemerintah. Kami mendorong agar pegawai ASN atau pejabat berbakat di dalam lembaga Saudara untuk mendaftar ke program dimaksud.

**ISI BERITA**

Merujuk perihal pada pokok berita, dengan hormat disampaikan hal-hal sebagai berikut:

1. KBRI Seoul telah menerima surat dari Mr. Kim, Hyun-Chul, Profesor dan Dekan, *Graduate School of International Studies Seoul National University (SNU GSIS)* telah menyampaikan

Beasiswa Program KOICA-SNU Master's Degree Program dalam bidang Energy Policy, Fall Semester Tahun 2023 (Salinan terlampir).

2. Mulai tahun 2023, SNU-GSIS akan memberikan pendidikan tentang Kebijakan Energi. SNU GSIS berupaya menyediakan program magister multidisiplin dalam Kebijakan Energi untuk pejabat pemerintah dari negara mitra termasuk Indonesia. Program pendidikan Master di bidang Energi terdiri dari kerjasama industri, pemerintah, dan akademik, dan akan memberikan pengetahuan akademik melalui studi kasus dan pendidikan di bidang Kebijakan Energi.
3. Berbagai fasilitas yang akan diberikan kepada penerima KOICA-SNU Master's Degree adalah;
  - a) Biaya kuliah selama 3 semester reguler, termasuk sesi musim panas/musim dingin
  - b) Tiket pesawat pulang pergi
  - c) Tunjangan bulanan- 999.000 KRW
  - d) Akomodasi
  - e) Biaya kegiatan ekstrakurikuler, termasuk berbagai acara, konferensi, dan kunjungan lapangan
  - f) Biaya asuransi
  - g) Dukungan penyelesaian - 600.000 KRW
  - h) Dukungan pengembalian - 300.000 KRW
4. Pelamar harus menyerahkan formulir yang diminta oleh Kantor DCPD SNU paling lambat 16 April 2023 dan kantor KOICA. Calon pelamar dapat merujuk ke halaman 3 hingga 6 dalam buku panduan program terlampir untuk informasi tentang dokumen yang harus disampaikan. Jika masih ada yang ingin ditanyakan, silahkan menghubungi kantor SNU-GSIS melalui Email: [koica.gsis@gmail.com](mailto:koica.gsis@gmail.com) / +82-2-880-6877. Silahkan check video tentang program dimaksud melalui link berikut: <https://www.youtube.com/watch?v=iqUbi1v1zGs&t=13s>

#### **Catatan KBRI**

5. SNU saat ini menduduki ranking ke 56 kampus terbaik di dunia versi *The Higher Education (THE) Ranking 2023*. SNU yang didirikan pada tahun 1946 merupakan salah satu perguruan tinggi terbaik versi THE di Korea Selatan (Korsel). SNU terdiri dari enam belas program studi, satu sekolah pascasarjana dan sembilan sekolah profesional. Saat ini terdapat sekitar 17.000 mahasiswa program sarjana dan 11.000 mahasiswa pascasarjana yang terdaftar pada SNU.
6. Kami memandang kesempatan ini sangat tepat bagi ASN dan peneliti Indonesia dalam menunjang kebutuhan sumber daya manusia di pemerintahan agar dapat mendukung berbagai kebijakan bidang energi yang sedagn mejadi prrioritas pemerintah Indonesia. Terlampir disampaikan penjelasan proses rekrutmen calon mahasiswa dan informasi lainnya terkait SNU-GSIS program.

Demikian kami sampaikan, atas perhatian dan kerjasamanya diucapkan terima kasih.

Seoul, 27 Maret 2023

Petugas Komunikasi



Taufik Rizqiansyah



Digital signed by  
UNITKOM-ITER  
Date: 2023-03-29 18:09+08:00

Pembuat Berita

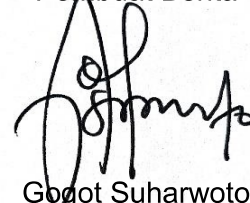

Gogot Suharwoto

Atase Pendidikan dan Kebudayaan

# KOICA-SNU Master's Degree Program in Energy Policy

August 15, 2023 – December 31, 2024

Seoul & Seongnam, Republic of Korea



Korea International Cooperation Agency



Graduate School of International Studies  
Seoul National University

*\*Participants are strongly advised to thoroughly read and follow the provided instructions in the Program Information.\**

# Contents

I . PROGRAM OVERVIEW .....	1
II. HOW TO APPLY .....	3
III. PROGRAM CONTENTS .....	6
IV. TRAINING INSTITUTE .....	16
V . ACADEMIC REGULATIONS.....	22
VI. PRECAUTIONS .....	24
VII. CONTACTS .....	25

## I . PROGRAM OVERVIEW

### ■ Program Title: KOICA-SNU Master's Degree Program in Energy Policy

### ■ Duration

- **Stay duration: August 15, 2023 - December 31, 2024** (Approx. 17 months of study in Korea)

**Students must complete their thesis within the 17 month study period.**

- **Academic duration: September, 2023 - February, 2025** (19 months)  
In accordance with university regulations, diplomas will be issued in February 2025.

### ■ Degree: Master of International Studies (International Development)

### ■ Objectives

- **(Program Objectives)** This program aims to train leaders in the field of energy policy to lead political, cultural, and institutional changes in national development by applying an energy perspective. With a focus on energy and environmental policy making, the program aims to train capable leaders in order to strengthen the organizational and institutional capabilities of relevant government departments or institutions that establish energy and environmental policies and contribute to the socioeconomic development of partner countries. By sharing knowledge, skills, and experiences of Korea's energy policy field with energy practitioners and managers in developing countries, the program intends to support individual capacity building as well as foster the ability to benchmark related excellent energy policies. This program aims to educate future-oriented energy policy experts who can formulate, implement, and evaluate policies pursuing sustainable growth based on critical and logical thinking.
- **(Expected Outcomes)** The program will cultivate expertise and leadership in establishing, implementing, and evaluating national policies in the energy and environment fields. In turn, the capabilities of individuals and organizations responsible for practical affairs and policy making in the fields of energy, resources, and environment will be strengthened, thereby contributing to the establishment of institutions and policies pertaining to energy and environment in partner countries. By fostering leaders in the fields of energy policy, the program will foster the achievement of sustainable socioeconomic development of partner countries.

■ **Training Institute: Graduate School of International Studies, Seoul National University**

■ **Number of Participants: 15 government officials**

■ **Qualifications:**

- Public officials or public sector workers
- Applicants who are associated with government ministries, public institutions or other ministries related to external relations and all sub-agencies of the related ministries and agencies. 'Public sector workers' refer to those who are currently employed in state-run institutions such as state-run enterprises/banks/laboratories/national public schools.
- Preference for applicants with 3 or more years of international experience or on-field experience
- Preference for applicants who have attended seminars related to energy/environment policy
- Additional points are given to applicants who have official English test scores.
- Applicants under 40 years of age

■ **Language: English proficiency that requires no translation**

■ **Accommodations:**

**Seoul National University Dormitory (SNU Gwanak Residence Halls, Gwanaksa):**

This dormitory is located within walking distance to GSIS on the Seoul National University campus.

- Double occupancy: 2 people per room
- Each room is furnished with two beds, two sets of desks and cabinets, a LAN port, an air conditioner and a shower booth.
- Communal Area (Shared): Kitchen, Reading Room, Laundry and Drying Room and Lounge
- Halal food is NOT offered in the dormitory cafeteria.

## II. HOW TO APPLY

### <A two-track approach of an application process>

#### - For KOICA documents;

- KOICA documents (KOICA application form) should be sent to the regional KOICA office or the relevant government office
- an original copy should be sent to the regional KOICA office or the relevant government office with the sealed envelope for your privacy protection.

#### - For university documents;

- a scanned copy should be sent to the official university email ([koica.snu@gmail.com](mailto:koica.snu@gmail.com))
- an original copy should be sent to the regional KOICA office or the relevant government office with the sealed envelope for your privacy protection till the end of local medical checkup. (After the medical checkup, an original copy should be handed to the university directly by the applicant)

#### ▣ Required documents

#### 1. KOICA documents (should be submitted to the regional KOICA Office or the relevant government office)

※ An original copy of the document should be submitted to the regional KOICA office or the relevant government office with a sealed envelope for your privacy protection.

※ For more information on KOICA documents, please contact KOICA directly

1) KOICA Application Form

2) An Official Recommendation Letter (or a referral) from the government of the applicant

3) A Scanned copy of the Applicant's Passport (please check the expiration date).

#### 2. University documents (should be submitted to University via an official university email)

#### ※ Application Method

**All documents must be submitted both with one PDF file (merged PDF file for all documents) and each file separately.**

**Deadline for submission: April 16<sup>th</sup>, 2023 (Sunday) 23:00 (Korea Standard Time) via the official university email ([koica.snu@gmail.com](mailto:koica.snu@gmail.com))**

An original copy of the document should be submitted to the regional KOICA office or the relevant government office with the sealed envelope for your privacy protection till the end of local medical checkup. (After medical checkup, an original copy should be handed in to the university directly by the applicant)

\* (Required) KOICA documents and university documents must be sealed separately and original copy should be submitted.

- 1) Seoul National University Form 1: Application Form
  - All information must be written correctly
- 2) Seoul National University Form 2: Personal Statement and Study Plan
  - **Filled out in English**
- 3) Seoul National University Form 3: Recommendation from two different professors with a stamp or signature on the sealed envelope by the recommender.
  - **Download two copies, each to be completed by two of your professors.**
  - **Signature of recommender and date of signature must be filled out**
  - **This document must be submitted in the format given (form 3), apart from the recommendation letter submitted to KOICA**
- 4) Official Bachelor's Transcript and Degree or Graduation Certificate
  - Documents written in Korean or English are acceptable.
  - Official academic transcripts must contain grades for all semesters
  - An original document must be submitted. Applicants submitting a copy must submit a notarized copy.
  - For transcripts or certificates written in languages other than English or Korean, applicants must submit **a notarized translated copy with the original document.**
  - Transcripts and Certificates from Chinese universities **MUST** be accompanied by verification from the China Academics Degree & Graduate Education Development Center. (Refer to the website: <http://cdgdc.edu.cn>)
- 5) A copy of the Applicant's Passport
  - Other official documents that verify one's nationality are acceptable (ex. Identification Card). In this case, a notarized copy must be submitted.
  - Passports or other documents must be valid
  - For documents written in languages other than English or Korean, **a notarized English translation must be submitted with the original document**
- 6) Copies of Parents' passports
  - Other official documents that verify one's nationality are acceptable (ex. Identification Card). In this case, **a notarized copy** must be submitted.
  - Passports or other documents must be valid
  - For documents written in languages other than English or Korean, a notarized English translation must be submitted with the original document
  - For those submitting a birth certificate for verification of nationality for one's parents, applicants must submit birth certificates for each parent respectively



- 7) Official document indicating a parent-child relationship between the applicant and their parents: Applicant's Birth Certificate or Household Register proving the parent-child relationship
  - All documents verifying a parent-child relationship must be submitted with original documents or notarized copies. (**\*Copies other than the original document must be notarized**)
  - For documents written in languages other than English or Korean, a notarized translated version must be submitted with the original document (**\*Notarized English translation is required**)
  - In the case of deceased parents or divorced parents, relevant proof needs to be submitted, such as Death Declaration Certificate or Divorce Certificate
  - Official documents for deceased or divorced parents must have a clear description regarding parental rights(custody)
- 8) Curriculum Vitae
- 9) Certification of Employment and Career Certificate
- 10) Preference is given to applicants who have acquired a certificate as proof of English Proficiency (Please submit a score report of a recognized English Proficiency Test such as TOEFL, TEPS, IELTS or any other supporting documents which demonstrate English language proficiency)

**\* Important Notes for All Applicants:**

- All forms should be **filled out in English** and all the supporting documents should be in English.
  - **Documents in any other language should be accompanied by a notarized English translation.**
- **Original documents should be submitted.**
  - If unavailable, the originating institution must authorize copies before they are submitted.
- **Submitted documents will not be returned. If the original documents are unavailable for submission, copies are suggested. In that case, however, these copies must be notarized.**
  - If any of the submitted materials contain false information, admission will be rescinded.
  - Applicants whose forms and supporting documents are incomplete or unsatisfactory will be disqualified from the admission process.
  - Applicants should take full responsibility for any disadvantages incurred due to mistakes or omissions on the application.- **Accepted applicants, before enrollment, must submit their degree certificate (or diploma) and academic transcripts. The two documents, regardless of whether they are the original documents or copies, must be notarized by the Embassy of the Republic of Korea in the applicant's country or notarized with an apostille stamp.**

### III. PROGRAM CONTENTS

#### 1. ACADEMIC SCHEDULE

Session	Date (YYYY.MM.DD)	Remarks
<b>Preparatory Session (Pre-Courses)</b>	2023.08.15	Arrival in Korea KOICA Orientation
	2023.08.16-2023.08.31	Basic Economics, Basic Statistics. Basic Korean, Education on Sexual Harassment Prevention, Human Rights, Crime Prevention (held separately)  DCPP Orientation, Entrance Ceremony, Campus Tour
<b>Fall Semester (1st semester)</b>	2023.09.01-2023.12.14	3 courses (9 credits) Basic Korean course (held separately) Seminar on International Development Policy (3-4 times) Field Trip & Industrial Visits (1-2 times)
	2023.10.23-2023.10.27	Mid-term Exam
	2023.10.31-2023.11.07	Course Registration for Winter Semester (2 <sup>nd</sup> semester)
	2023.12.04-2023.12.08	Final Exam
<b>Winter Semester (2nd semester)</b>	2023.12.23-2024.01.25	2 courses (6 credits) Basic Korean course (held separately)
	2024.01 (1 <sup>st</sup> week)	1 <sup>st</sup> Thesis Workshop
<b>Winter Break</b>	2024.01.25-2024.02.29	Korean Culture Experience Program (1 time)
<b>Spring Semester (3rd semester)</b>	2024.03.04-2024.06	3 courses (9 credits) Korean Language and Culture <sup>1</sup> , substitute foreign language course for Thesis Qualification Examination (held separately) Seminar on International Development Policy (3-4 times) Field Trip & Industrial Visits (2 times)
	2024.03 (1 <sup>st</sup> week)	Application for Thesis Qualification Examination (TQE)
	2024.03 (2 <sup>nd</sup> week)	Thesis Qualification Examination (TQE)
	2024.03 (2 <sup>nd</sup> week)	2 <sup>nd</sup> Thesis Workshop (Abstract and framing plan review)
	2024.04 (2 <sup>nd</sup> week)	Midterm Exam

	2024.05 (2 <sup>nd</sup> week)	Course Registration for Summer Semester (4 <sup>th</sup> semester)
	2024.05.09-2024.05.20	Thesis Proposal (Submit Confirmation Sheet of Master's Thesis)
	2024.06 (1 <sup>st</sup> week)	Final Exam
<b>Summer Semester (4<sup>th</sup> semester)</b>	2024.06.20-2023.07.29	3 courses (9 credits)
	2024.06 (3 <sup>rd</sup> -4 <sup>th</sup> week)	Field Trip & Industrial Visits (1 time)
	2024.07 (2 <sup>nd</sup> week)	3 <sup>rd</sup> Thesis Workshop (Midway check of thesis)
<b>Summer Break</b>	2024.08 (2 <sup>nd</sup> week)	Register courses for Fall Semester (5 <sup>th</sup> semester)
	2024.08.01-2024.08.31	Write thesis Korean Culture Experience Program (1 time)
<b>Fall Semester (5<sup>th</sup> semester)</b>	2024.09.01-2024.12.09	2 courses (6 credits) Seminar on International Development Policy (3-4 times)
	2024.10 (3 <sup>rd</sup> week)	4 <sup>th</sup> Thesis Workshop (Guideline for thesis format, submission and binding)
	2024.10 (3 <sup>rd</sup> week)	Midterm Exam
	2024.11.07-2024.11.18	Thesis Defense
	2024.12 (1 <sup>st</sup> week)	Publish thesis
<b>Wrap-up Session</b>	2024.12 (3 <sup>rd</sup> week)	Graduation Ceremony (Diploma issued in Feb <b>2025</b> )
	2024.12 (3 <sup>rd</sup> week)	Departure

*\*The above schedule is subject to change.*

*\*\*A detailed Program Schedule will be provided upon arrival.*

*\*\*\*Program start date may be subject to change due to COVID-19.*

## 2. CURRICULUM

### 1) Curriculum & Credits

- Credits required to complete the Master's Program: 39 credits (3 credits per course)

	Type	Course Title
<b>Preparatory Session</b> (non-credit)		<ul style="list-style-type: none"> <li>• Basic Economics</li> <li>• Basic Statistics</li> <li>• Basic Korean</li> </ul>
<b>2023 Fall</b> 3 courses (9 credits)	Required	<ul style="list-style-type: none"> <li>• Energy and Sustainable Development</li> <li>• Understanding of International Economic Relations or Understanding International Cooperation (1)</li> <li>• Research Methodology and Skills or Comparative Methodology(1)</li> <li>• Basic Korean (preparatory class &amp; non-credit)</li> </ul>
<b>2023 Winter</b> 2 course (6 credits)	Required	• Basic Korean (non-credit)
	Electives	<ul style="list-style-type: none"> <li>• Economics of Energy/Technology</li> <li>• Global Development and Development Cooperation (Thesis Workshop1)</li> </ul>
<b>2024 Spring</b> 3 courses (9 credits)	Required	• Korean Language and Culture (non-credit)
	Electives	<ul style="list-style-type: none"> <li>• Understanding Science and Technology Innovations and Development</li> <li>• Environment and Development</li> <li>• Understanding International Development Cooperation</li> </ul>
<b>2024 Summer</b> 3 course (6 credits)	Electives	<ul style="list-style-type: none"> <li>• Sustainable Energy and Climate Transition</li> <li>• Future Energy Systems and Science Policy</li> </ul>
<b>2024 Fall</b> 2 courses (9 credits)	Required	• Dissertation Research
	Electives	<ul style="list-style-type: none"> <li>• Economic Growth and International Development</li> <li>• Implementation and Evaluation of Aid Projects</li> <li>• Understanding Sustainable Development</li> </ul>

\* The above curriculum is subject to change.

\*\* A detailed Program Schedule will be provided upon arrival.

\*\*\* Some courses may be conducted online due to Covid-19.

## 2) Curriculum and Course Description

- **Energy and Sustainable Development**

Affordable, abundant and reliable energy is fundamental to human well-being and prosperity. This course teaches you everything you need to know about energy, the environment, and at least a number of things in everyday life. It starts by exploring concepts of sustainable development and topics that are involved. Then, we continue to learn about energy itself and where it comes from. This includes how much we have, who has it, who uses it, and what that all means. Then, we explore important global energy issues including peak oil, oil depletion, climate change driven by fossil fuel combustion, global oil market, and so on. Consequently, this course will help students acquire energy-related basic concept and knowledge, in relation to sustainable development, so that they can offer insights on what we must do to create pathways to achieve our goals for 21st century energy transition.

- **Sustainable Energy and Climate Transition**

This course aims to review critical energy-related issues and energy policies, and consequently seeks for desirable energy policy and planning to realize sustainable society. It will challenge students to consider how one might improve societies of poverty while also mitigating greenhouse gas emissions. We explore the inherent complexity of developing country governments wanting to grow their economies in a climate friendly way.

- **Understanding the Innovation and Development of Science and Technology**

This lecture will comprehensively deal with the impact of science and technology innovation on economic growth, economic development, and development cooperation. Along with the development of science and technology, labor and the accumulation of human and material capital are important factors in economic growth. Out of the above, it is appropriate to remark that the development of science and technology is the essential factor for increases in productivity, also determining the characteristics of economic development. Science and technology also have a profound effect on income distribution, poverty, urbanization, structural changes in agriculture, industrial development, and environmental protection. In this regard, scientific and technological innovation must be taken into consideration when developed countries support economic development in developing countries. It is important to find ways to enable developing countries to achieve economic development without trial and error or waste by using the most suitable technologies that the developing countries need.

- **The Economics of Energy and Technology**

This lecture covers a wide range of areas, including topics related to the supply and use of energy. Considering the cost of energy services and their associated value, the efficiency in producing energy

is given economic significance. The efficiency of energy services relates not only to the engineering technologies used to produce and supply energy, but also to the economic efficiency associated with the operation of the system. The main sectors considered in energy economics include the supply side and the demand side, also relating to a wide range of human activities, including resource and environmental impacts.

- **Future energy systems and science policy**

This course deals with the energy system transformation for sustainable future. In this course, students are equipped with characteristics and requirements of sustainable energy systems, and we look into science and technology policy for the system transformation. The course will provide students with cutting-edge trends of STI policy studies and information on possible alternatives like hydrogen, renewables, and sustainable road transportation. The aim of the course is to stimulate students to think and act as future intellectuals by crossing the frontiers of science, STS, and science policy on energy systems.

- **Environment and Development**

This seminar course examines environmental issues in developing countries, such as air pollution, management of the commons, climate change, energy use, and public health. This course connects the foundation of microeconomics with real-life household and firms' decision-making on environmental issues. Students will be exposed to basic empirical techniques and the latest examples that identify with and/or evaluate key environmental problems in development. The main goal of this course is to discuss the possible economic causes and consequences of environmental issues and to be cognizant of the various government and market-based solutions to environmental issues in development.

- **Understanding Sustainable Development**

This graduate course provides a rigorous introduction to sustainable development. This course will enable students to understand the interactions between physical ecology and economic development, and gain a deeper understanding of the ways in which they impact each other. Ecological constraints (climate, disease ecology, physical resources such as soils and energy sources, topography and transport conditions) significantly shape the patterns of economic development, demography, and wealth and poverty. At the same time, anthropogenic activities (farming, resource depletion, demographic stresses, and energy use) change the physical environment. Weekly discussions will explore the breadth of the field and the multidisciplinary nature of the scholarship to provide students with an understanding of economic development and its relation to nature's processes.

- **Implementation and Evaluation of Aid Projects**

This course introduces students to the complex and changing field of international development cooperation. Focusing on both multilateral and bilateral foreign aid, it will answer key questions such

as: Why do international donors give foreign aid? Who are the players and what are the issues in international development aid and lending? Why are developing countries interested in receiving development assistance? Does foreign aid work? How should we understand and evaluate past and current foreign aid and development assistance? Do foreign aid and loans do more harm than good?

- **Economic Growth and International Development**

The main goal of this course is for the students to gain theoretical perspectives and empirical tools in thinking about the central question of how to make poor countries rich, i.e. the issue of international development. To answer this question, we try to understand the sources of and barriers to economic growth and development, focusing on the differences in levels and rates of change of real per capita income across countries and the associated income distribution dynamics across countries. We will learn about these issues by using both economic models and data interactively and infer policy implications to promote economic development and welfare of nations.

- **Understanding of International Economic Relations**

As the world economy continues to globalize, international economic issues grow in importance and complexity, creating many new challenges for international economic relations. In this context, this course introduces the main concepts and methods of international economics and illustrates them with applications drawn from the real world.

- **Understanding International Cooperation**

The primary purpose of this course is to offer an overview of the field of international relations. It is designed to introduce basic theories, contemporary issues and problems in international relations. The first half of the course will examine major theoretical approaches and their critiques in the field of international relations, such as realism, liberalism, and constructivism. The second half of the course will discuss several contemporary issues and problems in international relations. Topics include security dilemma and war, international cooperation, international trade, international financial and monetary relations, poverty and development, foreign aid, and transnational and trans-governmental actors.

- **Understanding East Asia**

The purpose of this course is to familiarize students with key patterns of political change, economic development, and socio-cultural imagination in East Asia. The course briefly reviews the contemporary history of East Asia, before moving on to different perspectives of economy and business, society and culture, and politics and diplomacy. Topics include the development of East Asian capitalism, developmental states and democracy in East Asia, cultural understanding of Asian Values, and the concept of self and others in China, Japan, and Korea. The course will end with a consideration of recent social and political changes in East Asia in line with international resources.

- **Research Methodology and Skills**

The objective of the course is to provide the students with the tools to analyze issues in international and area studies. In the first part of the course, students will learn important concepts of statistics and acquire techniques to use Excel and other statistics programs. In the second part, students will learn how to calculate useful indices and statistics as well as how to analyze the relationship between various variables in international and area studies.

- **Comparative Methodology**

This course introduces comparative methodology as one of the core methodologies at a graduate level. This course provides students with a powerful tool to analyze the mechanism in which different outcomes result under similar conditions or similar outcomes result under different situations. This methodology can be applied not only to traditional times but also to contemporary times. In addition, comparative methodology can be applied to various research in which the unit of the analysis is an individual, a society, an event or an institution.

- **Understanding International Development Cooperation**

In this course, the concept, patterns, and problems of aid governance will be considered from an international or global perspective. International aid to developing and transition countries is one of the principal mechanisms by which policy makers and development practitioners seek to promote economic development and democratization in developing countries. South Korea was the first country to transit from aid-recipient to aid-donor, joining the OECD-DAC in 2010. By launching aid programs like ODA, the government and civil society are both facing the demand of aid specialists who can organize and manage Korea's foreign international and humanitarian aid to developing countries.

### **3) Graduation Requirements**

- ① A minimum of 39 credits is required for graduation (including a minimum of 9 credits from Practical Courses). GPA of 3.0 or higher out of 4.3 is required.
- ② Students must take the following 4 required courses:
  - Understanding of International Economic Relations OR Understanding International Cooperation
  - Research Methodology and Skills OR Comparative Methodology
  - Energy and Sustainable Development
  - Dissertation Research (Students must take "Dissertation Research" in their 3th Semester)
- ③ Students must take at least 3 courses (9 credits) in their GSIS major program.
- ④ Students must take at least 3 practical courses (9 credits).
- ⑤ Students must take at least 2 DCPD courses (6 credits).
- ⑥ Korean courses are mandatory (non-credit courses). Even though Korean classes are shown as 3-credit courses when you register for them during a semester, they will not be included in your overall GPA calculation.



- ⑦ Students can take undergraduate courses within 6 credits. However, students should seek advice from the Program Advisory Professor first, and then obtain approval from academic associate dean before registering for undergraduate courses.
- ⑧ Credits earned from other graduate schools are accepted up to 9 credits, including 6 credits from undergraduate programs.
- ⑨ Students should take at least 20 credits in GSIS programs regardless of circumstance.

## ➤ Thesis

### ① Thesis submission process

- In order to write a thesis, students must pass the Thesis Qualifying Exam(TQE). For students in this program, the thesis qualifying exam will be in English on the main subject, Energy and Sustainable Development.
- Once students meet the prior requirements, they can submit a thesis proposal to an advisor of their choice. Once the thesis advisor approves the proposal, students then must submit their proposal, together with the approval from the advisor to the administration office.
- As for the Korean exam, students can take a Korean course instead of taking the exam to receive a passing grade. In this case, grades received in the Korean course will not be included in the GPA. However, students will not be able to graduate if they fail the course.

### ② Thesis Screening Process

Period	Details
January 2024	Confirmation of Thesis Screening Committee
March 2024	Thesis Qualifying Exam
April 2024	Submission of the Thesis Proposal Application Form
May 2024	Submission of the Thesis Proposal and Thesis Abstract
May 2024	Thesis Proposal
June 2024	Submission of Thesis Proposal Results
November 2024	Submission of Thesis Defense Application Form
November 2024	Submission of Thesis Defense
November 2024	Thesis Defense
November 2024	Submission of Thesis Defense Result
December 2024	Completion of Thesis and Receipt

\* The above schedule is subject to change.

- ③ Aside from the 'Dissertation Research' course, students can choose one SNU GSIS professor as their thesis advisor before the second semester starts and this advisor will offer you 1:1 individual thesis guidance.
- ④ Thesis Workshops: Thesis Workshops will be held a total of 4 times during the academic year. Since the thesis writing timeline for this program is separate from other GSIS students, the DCPD Office will hold regular workshops to help students avoid any possible confusions. A general administrative guide throughout the thesis writing process will be provided during the workshops.

### 3. EXTRACURRICULAR ACTIVITIES (TENTATIVE)

#### 1) Field Trips & Industrial Visits \*Locations are subject to change.

- Central/Local Government Organizations: Ministry of Environment, Ministry of Interior and Safety, The Ministry of Trade, Industry and Energy, Korea Electric Power Corporation (KEPCO), Korea Energy Agency (KEA), Seoul Energy Corporation, Seoul Energy Dream Center
- Government Affiliated Research Institutes and Centers: Korea Institute of Energy Research, Korea Energy Economics Institute, Science & Technology Policy Institute, Korea Institute of Science and Technology Information
- Civil Society Organizations: Korea NGO's Energy Network, Korea Energy Foundation, Plan 1.5, Solution For Our Climate (SFOC)
- Private Sector: SK E&S, Hanwha Q CELLS, Bright Energy Partners, Hyundai Motor Company, Jipyeong LLC.
- Field trips are usually planned on a monthly basis, excluding months with mid-terms or final exams.
- Since field trips are a part of the official schedule of the whole program, prior approval from the professor in charge is mandatory for any cases of absence.

#### 2) Seminars on International Development Policy (3-4 times per semester)

The purpose of the seminar is to invite specialists and practitioners in the field of policy-making to provide a better understanding of the study. Through case studies and practical knowledge offered by experts, students gain valuable knowledge on how to apply Korea's experience to their home countries. Students actively interact with the specialists during the Q&A session. Participation is highly encouraged.

#### 3) Roundtables (once a week)

Roundtables are designed to provide students with opportunities to exchange their thoughts

and ideas on various issues in a more casual atmosphere. At SNU GSIS, multiple roundtables are actively run by students. Many students in this program participate in roundtables like the Korean Roundtable and the Developing Countries Roundtable. Each session is divided into two parts: presentation by students and subsequent discussions. Usually, roundtables take place during lunch time on weekdays.

#### 4) **Experiencing Korean Culture (2-3 times)**

Korean Culture Day is held once every winter and summer session. Korean Culture Day provides many activities for participants, allowing them to understand Korean culture and to acclimate to their new school environment more quickly.



## IV. TRAINING INSTITUTE

### 1. GENERAL INFORMATION

#### 1) About the University

Seoul National University (SNU) was founded in 1946 as the first national university in South Korea. As of 2021, the university is spread throughout 5 different campuses across South Korea, with over 1500 global partner institutions from over 100 countries. It is considered the most prestigious university in the country, with extremely competitive admissions. Gwanak Campus, the main campus of the university, is located at the foot of the magnificent Gwanak Mountain.

SNU offers its students not only the most excellent academic environment possible but also outstanding cultural and recreational opportunities with a wide range of additional entertainment options available in the city of Seoul. SNU has a student enrollment of approximately 27,924; 16,045 at the undergraduate level and 11,879 at the graduate level. About 2,141 full-time faculty members are appointed at SNU. Over 330,000 SNU alumni play a leading role in every sector of South Korean and global society.

The Graduate School of International Studies (GSIS) started as the Center for Area Studies in 1989 to foster research on region-specific issues and to respond to the increasing demand for global perspectives within Korea. In 1997, it expanded to the School of International and Area Studies (SIAS) which again expanded to the current GSIS in 2003.

Graduate School of International Studies of Seoul National University has 5 different majors: International Commerce, International Cooperation, International Area Studies, Korean Studies and International Development.

Since its foundation, GSIS achieved remarkable success in its quality education of international studies. The objective of GSIS education is to raise experts on international and global affairs who meet the challenges of globalization and normalization, are equipped with core skills, practicable expertise, problem-solving abilities, international awareness, and a future-orientated vision. GSIS educates global leaders for an increasingly complex global society. As both a professional and academic institution, it seeks to prepare its students to assume leading roles in government and non-government organizations, international organizations, multinational corporations, the media, as well as think-tanks and universities. The curriculum is based on an integrated, multidisciplinary approach, which connects theory with practice.

With the most prominent faculty in Korea specializing in International Commerce, International

Cooperation, International Area Studies, Korean Studies, and International Development Studies, GSIS provides a truly exceptional research and educational environment.

The student body is composed of highly qualified graduate students from all around the world. As a source of knowledge and skills, GSIS will continue to promote mutual understanding, peace and prosperity, both regionally and globally.

## 2) Homepage

- Seoul National University official website: <http://en.snu.ac.kr/>
- GSIS Official website: <http://gsis.snu.ac.kr/>

## 2. ACCOMMODATION

### 1) Dormitory of Seoul National University (SNU Gwanak Residence Halls, Gwanaksa)

Gwanak Residence Halls (Gwananksa) can accommodate 4,777 students from all over Korea and around the world. It provides residents with living quarters not only to study and relax but also to meet people from various backgrounds. Its double-occupancy (sharing a room basis) rooms are furnished with a shower room, two beds, two desks and two cabinets. Wi-fi service is available in each room.

- Homepage: <https://snudorm.snu.ac.kr/en/>
- Address: 1 Gwanak-ro, Gwanak-gu, Seoul 08826, Korea
- Tel: 82-2-881-9200 / Fax: 82-2-877-2892



(▲ SNU Gwanak Residence Halls for Graduate Students)

## 2) Layout of Double Occupancy Room (2 people sharing a room)

A double occupancy room will be provided for your accommodation (shared rooms) in Gwanak Residence Halls Bldg. 900-905 and 918, which is the accommodation building for graduate students.

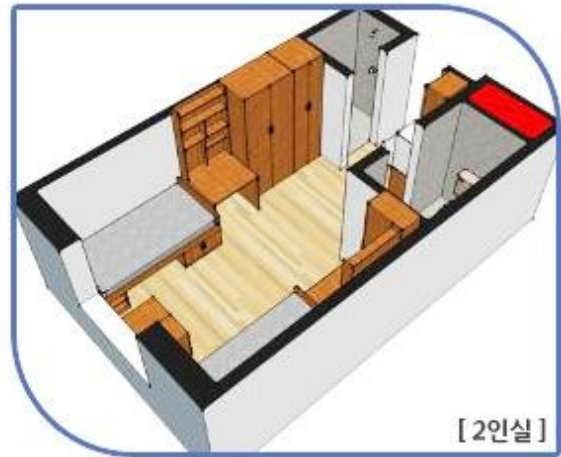

(▲ Double bed room)

## 3) Facilities

### ① Private Room

- A small refrigerator, a space separation screen and LAN cable provided
- A toilet and a shower booth
- Individual heating system
- Each room is furnished with two beds, two desks, two chairs, two book cases, and two wardrobes, two shoe shelves and a curtain.
- Each room is equipped with an air conditioner, a telephone, LAN port and 220V power outlet.
- Personal items including bed sheet, blanket and pillow are not provided.
- Possessing or using any of electric heating appliances is prohibited.

### ② Communal Area (shared)

- Kitchen: Microwave oven, cooking heater, refrigerator, water purifier, dining table, TV
- Laundry and drying room: Washing machine, electric iron, clothes horses
- Lounge: Snack vending machine, table, LAN port table for internet use
- Reading Room: Basement 1F, Building 900

### ③ Security

- CCTVs, card key, automatic door lock



(▲ SNU dormitory buildings and facilities)

## 4) Documents to be submitted (Very Important)

SNU requires all dormitory residents to be immunized against certain contagious diseases. To comply with this regulation, the Seoul National University Health Form <1. Immunizations (Measles)> and <2. Tuberculosis Screening> should be completed and signed by your health care provider, with the official seal of the hospital. Required vaccinations should be received prior to arrival. Therefore, before entering the dorms, final candidates must submit a soft copy of his/her SNU Health Form to the office via email ([koica.snu@gmail.com](mailto:koica.snu@gmail.com)) by the designated date (TBA) and submit its original copy when s/he comes to school in August 2023.

*\*The above documents will be required for applicants who are accepted to the program only. They will be submitted for the dormitory move-in application process.*

*\*\*Required documents are subject to change in line with any adjustments in the Korean government's policy for COVID-19. For further details on the COVID-19 test, we will keep notifying you of any updates including the type of test, etc.*



### 3. OTHER INFORMATION



(▲GSIS Buildings)

#### **- Program Administration Office (DCPP Office)**

The Office for the Energy Policy Program is located on the 3rd floor of the GSIS Bldg. 140 Room 203.

#### **- Student ID Card (S-Card)**

Paper application: Submit S-card application form and one COLOR PHOTO (3cm x 4cm) to the Student Support Center (Bldg. 67, Dure-moonyegwan 2nd Floor) at the beginning of the first semester after you obtain a Residence Card and update your student records to reflect the new Residence Number.

#### **- SNU Central Library**

The central library is located behind SNU's main administration building (Bldg. 62). You will need your student ID card to enter the library and to borrow books and other materials. Their website is <http://library.snu.ac.kr> which has extensive information. You can use your student ID card to borrow and extend the due date of books.

#### **- GSIS International Library**

In response to the needs of a new, globalized era and demands for skillful international specialists, the GSIS International Library was established and has currently been expanded. In addition to fostering prospective international specialists, the library has contributed to Seoul National University and played a pivotal role in building up the materials that are necessary and useful for domestic researchers of area studies. The library is preparing for the 21st century by producing and administering necessary materials. Recently it has developed into a branch library (International Studies Library) of Seoul National University and is open to international and Korean researchers.



### **- Dining on Campus**

There are more than 20 cafeterias and restaurants on the campus. Generally speaking, the food at restaurants are more expensive compared to the ones served in the school cafeterias. The nearest place to eat from the 906 Building (dormitory) is the cafeteria in the 901 Building, or the 220 Building. The “Our Home” cafeteria is also available close to the dormitories. The school cafeteria serves breakfast, lunch, and dinner. Some of them are open even during the weekends (“Our Home” and 919 Building Cafeterias). There is one restaurant offering Halal food and vegetarian food. The school cafeteria employs a self-service system where you first purchase a ticket for the menu item of your choice, queue up, get a serving tray and utensils, and receive the food you paid for. Once you are done eating, patrons return used trays and utensils to the kitchen. For a detailed campus map where you can locate the restaurants and cafeterias, please refer to the school website at:

<https://en.snu.ac.kr/about/campus/gwanak/address>

### **- Health Care Center**

If you have any health problems, there are two nearest medical centers to choose from:

#### ① Campus Health Service Center

(located on the 3rd floor of the Student Union Center) includes physicians, registered nurses, and a counselor and is equipped with a laboratory, radiology services, a pharmacy, and support staffs. Students fill in the medical information card on their first visit to the center and present their student ID card or any other ID. The staff of Campus Health Service Center can communicate in English. The operation hours are: Mon – Fri, from 09:00 to 17:30 (lunch break: 12:00 – 13:30). Please refer to the website listed below for more detailed information: <http://health4u.snu.ac.kr/en/index.do>

#### ② Boramae Medical Center

Boramae Medical Center is the nearest and one of the finest medical centers near SNU. Please refer to the website for more detailed information: [https://en.brmh.org/index/do](https://en.brmh.org/index.do)

## V. ACADEMIC REGULATIONS

### 1. Attendance and absence

- Students are expected to attend all of the classes they have registered for each semester. Any student who, without good reason, fails to attend class for at least two-thirds of the total courses shall fail the course.
- In the event a student is absent for any of the reasons below, the student must notify the appropriate department (contact the Program Administration Office), faculty, and dean for approval in advance.
  - ① Death of an immediate family member (parents, spouse, and children) or equivalent circumstance
  - ② Academic planning, field-trips, on-location training, etc.
  - ③ Participation in seminars or conferences (including international ones) as approved by the Dean
  - ④ Other events as approved by the Dean
- In the event of illness or emergency situations, students absent for less than seven days (including holidays and weekends) must submit a written notice of such absence to the Dean. For absences of more than seven days, students must submit a diagnosis by a written physician.

### 2. Must reside in dormitory

- Students must reside in the Gwanak Residence Halls (Gwanaksa) of Seoul National University.
- Living off-campus is not allowed.
- Cooking is only allowed in the dormitory cooking area (communal area).
- Induction, microwave, and water purifier can be used. Each floor has a communal kitchen.  
Cooking in a dormitory room is prohibited.

### 3. Must abide by residency regulations

- Seoul National University has very strict residency regulations and all students must abide by them.

### 4. Examinations and Grade Evaluations

#### ① Minimum Grade Point Average Requirements

Students must maintain a C- (70-73) grade point average at a minimum.

Anything below 70 points (F=69 and below) will not be acknowledged as a passing grade.

- Regular Exams and Make-up Exams

## ② Regular Exams: Mid-term and Final exams

Make-up Exams: In the event a student cannot take an exam due to illness, or any other emergencies, the student must notify the faculty in charge of class before the test date, and obtain the Dean's approval to take the exam at another time.

## ③ Qualification to take an exam

Any student who, without good reason, has failed to attend class for at least two-thirds of the total classes shall be prohibited from taking the exam. In the event of illness or emergency situations, students need to provide a written explanation of their absence.

## ④ Scholastic Performance Evaluation Method

Scholastic performance will be based on a 100 point score for each course registered. Grades will be based on classroom performance (presentations, attendance) and test performance (mid-term and final exams).

Grades will be calculated on a curve as follows:

- A to A+ : 30% of the students in the class
- B to A- : 40% of the students in the class
- B and below : 30% of the students in the class

## VI. PRECAUTIONS

1. **Possibility of Online Program:** According to arising circumstances due to the spread of COVID-19 and public health regulations thereof, the academic program within this PI may be switched online. In accordance with academic regulations of each training institute, blended learning (or hybrid learning, a combination of online and face-to-face learning) may be implemented, including pre-sessions.
  - In principle, even when the academic program is conducted online, participants must be physically present in Korea to participate (cannot participate in the program online from home country or outside Korea).
2. **Early Departure:** Due to various circumstances such as no flights operating or border closures, participants may be required to depart Korea before the program end date.
  - In such cases, part of the academic curriculum, thesis defense, or closing ceremony may be conducted online.
3. **Living Costs:** In principle, costs of living are provided per diem; that is, participants receive living costs per diem based on the actual date of departure.
  - In case of early departure, living costs are received per diem based on the date of early departure, and NOT the anticipated departure date or program end date
4. **COVID-19 Test Fees:** The costs of COVID-19 testing required by quarantine regulations during the departure and arrival process are first incurred by the participant and later reimbursed via the Settlement Allowance and Scholarship Completion Grants.
5. **Adherence to Entry/Departure Guidelines:** Any additional costs occurring due to the participant's failure to adhere to the entry/departure guidelines are the participant's own responsibility.
  - Example) If the participant fails to provide a COVID-19 PCR test certificate on the date of arrival, or is delayed in arriving at the airport and fails to board the flight, any additional costs occurring thereof (flight change fees, etc.) is to be paid by the participant.
6. **Vaccination requirements:** Participants are to individually check with the training institute on whether vaccination is required and prepare accordingly; any disadvantages following are the participant's own responsibility.
  - Example) If the participant fails to provide a proof of a WHO-certified vaccination and cannot check into the university dormitory, the participant will be responsible to find accommodation for him/herself (accommodation fees are supported in the amount corresponding to the dormitory fees).
7. **Check-in to Dormitory:** In principle, dormitory check-in is required of program participants.
8. **Religious meals & personal food preferences:** Religious meals and personal food preferences are not provided during the scholarship program nor the self-quarantine period following entry to Korea. For further information, check the university guidelines (if necessary, personal fees may be incurred)
9. **Regulatory Compliance:** KOICA SP participants should observe KOICA CIAT Fellows' Guidebook and University internal rules and regulations, otherwise the participant would lose one's status as SP participants and a university student.

## VII. CONTACTS

### 1. CONTACT INFORMATION

#### 1) Graduate School of International Studies (GSIS), Seoul National University (SNU)

**Program Manager : Ms. Jeonghye PARK**

Development Cooperation Policy Program (DCPP)

- Address: GSIS Bldg. 140, Suite 203, Seoul National University, 1 Gwanak-ro, Gwanak-gu, Seoul (08826)
- Tel: +82-2-880-6877
- E-mail: [koica.snu@gmail.com](mailto:koica.snu@gmail.com)
- Homepage: <http://gsis.snu.ac.kr>

#### 2) General requests regarding application process

- E-mail : [koica.sp@koworks.org](mailto:koica.sp@koworks.org)
- Homepage : <http://www.koica.go.kr/sites/ciat/index.do>

\*\*\*The schedule in PI (Program Information) is subject to change according to the KOICA and Graduate School of International Studies, Seoul National University's schedule.\*\*\*